

# Manual Radiometer 8

—  
GUVX-T1XGS8

Genuine UV Technology

GenUV

# MG-08

**GUVX-T1XGS8-L(LA9.2)**

User Manual

## 1. Product Feature and Specifications

Description : GUVX-T1XGS8-L series is portable instruments with LCD display.

GUVX-T1XGS8-LA9.2 series is probe type portable instruments with LCD display.

Item	TOTAL UV (UVA+B)	UVB	UVC	UVC-LED	Far UV	Blue light	UV INDEX
Model Name	<sup>1)</sup> GUV-T10GS8	<sup>2)</sup> GUVB-T11GS8	<sup>3)</sup> GUV-T10GS8	<sup>4)</sup> GUVL-T11GS8	<sup>5)</sup> GFUV-T10GS8	<sup>6)</sup> GVBL-T12GS8	<sup>7)</sup> GUM-T11GS8
Detection	0.00 ~ 99.99 mW/cm <sup>2</sup> *						0~50.0 UVI
Spectral Detection Range	230 ~ 395 nm	220 ~ 320 nm	220 ~ 280 nm	220 ~ 320 nm	~250nm	330 ~ 445	220 ~ 320nm
Calibration Peak Point	365 nm (LED)	306 nm (Lamp)	254 nm (Lamp)	285 nm (LED)	222nm r lamp	385/405 nm (LED)	Solar simulator
Resolution	0.1 uW/cm <sup>2</sup>						0.1 UVI
Function	Absolute Power (mW/cm <sup>2</sup> ), DOSE (J/cm <sup>2</sup> , Accumulative time : Max. 24hour.), Max Power (mW/cm <sup>2</sup> )						Index(UVI)
Conversion	2 Times /Sec						
Display	128x64 Graphic LCD						
LCD Size	17 x 35 mm						
Operation	0 ~ 60 °C						
Operation	RH 10 ~ 85 %						
Accuracy	±10 % (NIST Traceable)						
Product Size	73 x 139 x 31 mm						
Weight	Main body : 100 g (without battery)						
Power Source	DC 9V Battery						

\* Customization is available (Maximum of detection power : 10W/cm<sup>2</sup>)

## 2. Relative Response Curve

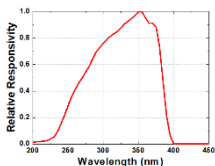

1) GUVW-T10GS8-L(LA9.2)

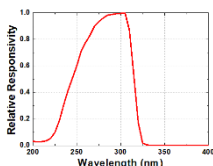

2) GUVB-T11GS8-L(LA9.2)

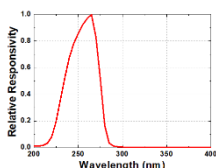

3) GUVV-T10GS8-L(LA9.2)

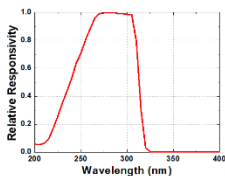

4) GUVL-T11GS8-L(LA9.2)

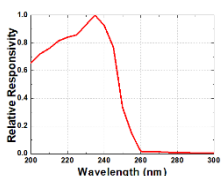

5) GFUV-T10GS8-L(LA9.2)

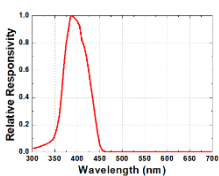

6) GVBL-T12GS8-L(LA9.2)

## 3. Warning



Wear protective gear when monitoring UV lamps.



Allow lamps to warm-up prior to taking reading (at Least 5 minutes).



Do not subject the meter to extremes in temperature, humidity,



When the surface contamination of the product, wipe with a



Keep sensor free of oil, dirt, etc.



Do not disassemble if modification.

## 4. Part Names

### 4-1) Front side

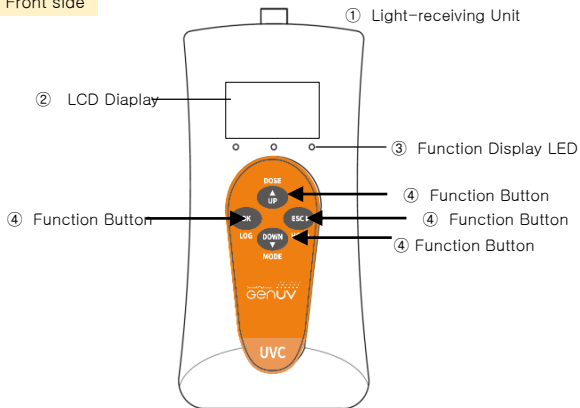

[UV Radiometer 8 front side]

① Light-receiving Unit

② LCD Display  
This is 4-digit LCD display.

③ Function Display LED

- Red : Logging
- Green : DOSE
- Yellow : UVC SAFE

④ Function Button

OK Button : Press 1 second to perform logging/more 3 second to enter menu

ESC Button : Press 1 second to reset DOSE value and Max. Power.

Press short to measure pause, start

UP Button : Press 1 second to perform DOSE, Press again for 1 second to stop DOS

DOWN Button : Press 1 second to set information mode, DOSE graph, UVC Safe measurement mode.

4-2) Back side

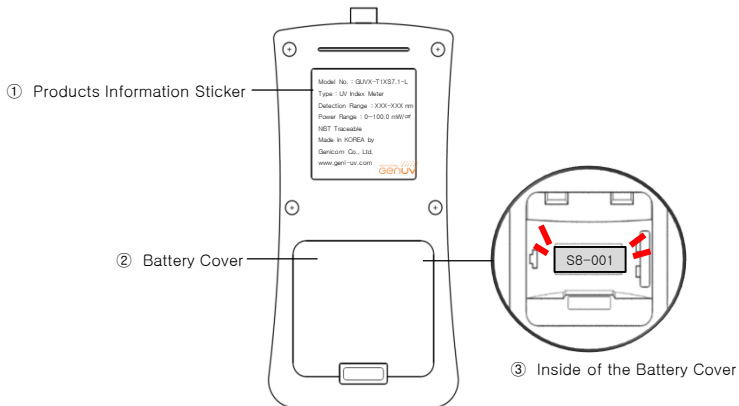

[UV Radiometer 8 back side]

① Product Information Sticker

Model No. : GUVX-T1XS-L	Model Name
Type : UV Index Meter	Product Name
Detection Range : XXX-XXX nm	Measurement wavelength range
Power Range : 0~100.0 mW/cm <sup>2</sup>	Measurement light power range
NIST Traceable	
Made in KOREA by	
Genicom Co., Ltd.	
www.geni-uv.com	

② Battery Cover

This is a 9V battery cover.  
 Open the battery cover to insert and replace the battery.

③ Inside of the Battery Cover

the Serial number is here.

## 5. Product Operation Guide

### 5-1) Battery check

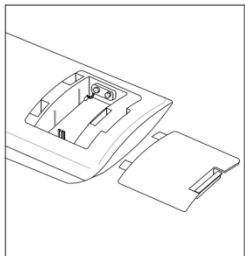

Open the battery cover in the back of main unit and check for a 9V battery is or isn't.

### 5-2) Warning for battery replacement

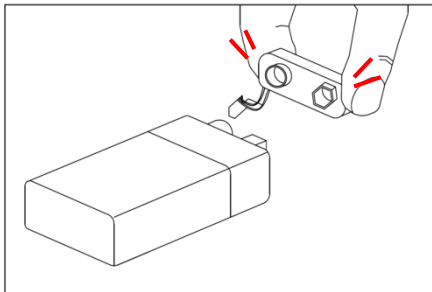

Pulling the connector forcibly can cause it to break.  
Please hold the battery connector and detach the battery

### 5-3) Power ON and Off

Press the ESC button shortly for power ON, Press 3 second for Power OFF.

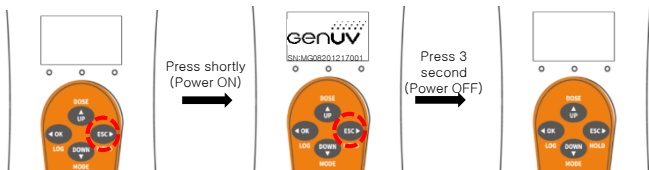

### 5-4) Function Button

Press OK button for 1 second to start logging. Press again for 1 second to exit at logging.

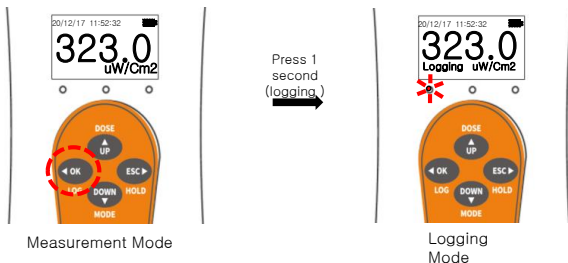

Press UP button for 1 second to start DOSE. Press again for 1 second to exit at DOSE.





Press the DOWN button for 1 second to cycle into measurement mode, information mode, DOSE Graph mode, UVC Safer mode and measurement mode.

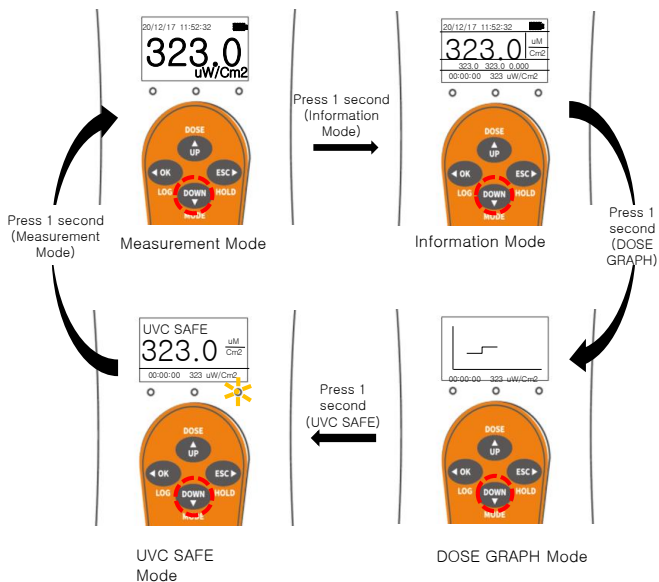

Press the ESC button shortly to pause the measured value. Press again shortly to display the measured value.

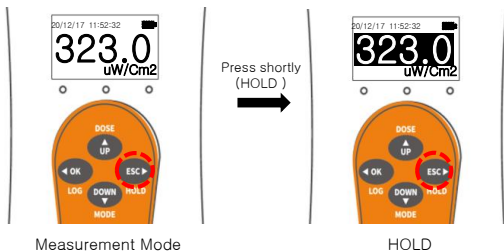

Press the ESC button for 1 second to resets DOSE, Min, Max, Avg, and measured values to 0.

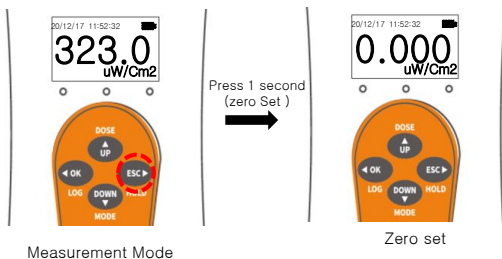

## 5-5) Menu Setting

Press the OK button for 3 seconds to display the setting menu.

In the setting menu, you can set the date, time, set the network mode, adjust the backlight brightness, export the saved log, set the relay, set the sleep time, and check the serial number.

To exit from the menu mode, press the ESC button or select 8.Exit and press the OK button for 3 second to exit the measurement mode.

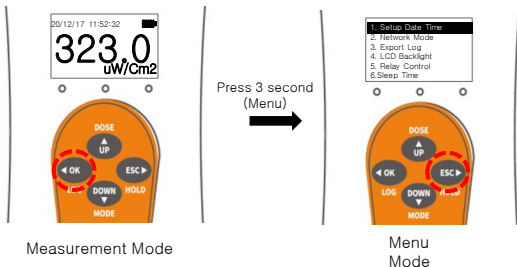

### Date and Time Setting

In the menu mode, select 1.Setup Date & Time by using the UP and DOWN buttons.



Move using the left and right buttons and press the UP and DOWN buttons to increase or decrease the number.

After completing the adjustment, press the OK button for 1 second to save and return to the menu mode.

To cancel the time adjustment, press the ESC button for 1 second to return to the menu mode.

## Changing Network Mode

In the menu mode, select 2. Network Mode by using the UP and DOWN buttons.

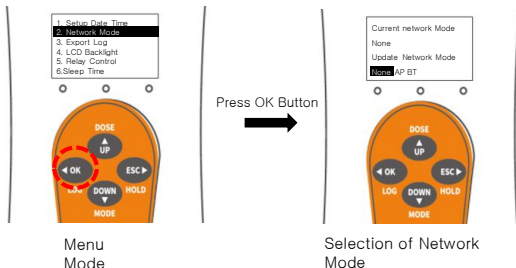

Select a mode using the left and right buttons, and press the OK button for 1 second to reflect the network mode and return to the menu mode.

When using the network mode, battery consumption is large, so if you set it to None after using it for log transmission, you can reduce battery consumption.

## Export Log

In the menu mode, select 3. Export Log by using the UP and DOWN buttons.

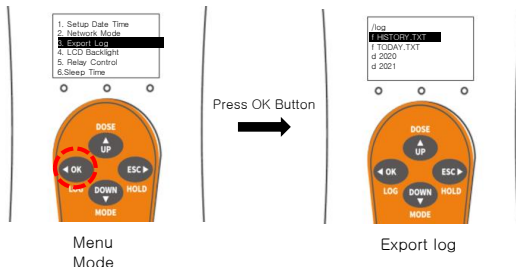

'd' means a directory and 'f' means a file.

Select the year in which the log is saved by using the UP and DOWN buttons and press the OK button.

Select the month in which the log is saved by using the UP and DOWN buttons and press the OK button.

Select the log file and press the OK button to send the log file to the serial.

When the transmission is finished, it returns to the measurement mode.

### Changing a LCD backlight brightness

In menu mode, select 4.LCD Backlight by using the UP and DOWN buttons and press the OK button.

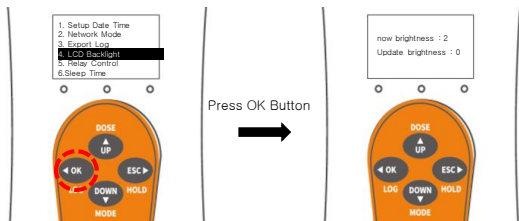

Menu  
Mode

Changing a brightness

Set the brightness by using the UP and DOWN buttons, and press the OK button for 1 second to reflect the brightness and return to the menu mode.

If you use it brightly, it consumes a lot of battery, so if you set it low, you can reduce battery consumption.

### Changing a relay operation condition

In the menu mode, select 5.Relay Control by using the UP and DOWN buttons.

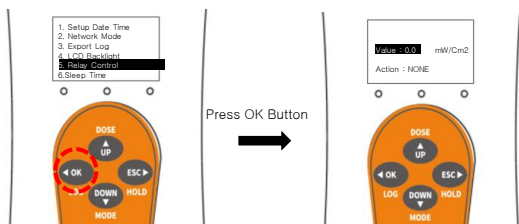

Menu  
Mode

Changing a relay operation condition

Use the button to set the light intensity, unit, and relay operation to operate the relay, and press the OK button for 1 second to save and return to the menu mode. If cancel adjust condition, Press ESC Button for 3 second.

### Changing a sleep time

In the menu mode, select 6.Sleep Time by using the UP and DOWN buttons.

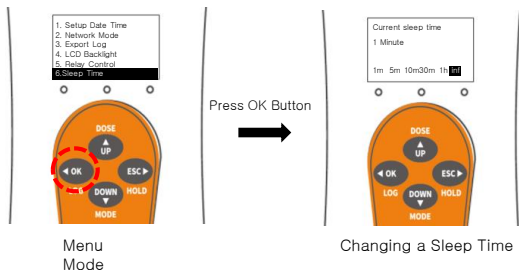

1m of 'm' means minutes, 1h of 'h' means hours, and 'inf' means keep working. Select the mode using the left and right buttons and press the OK button for 1 second to reflect the Sleep Time and return to the menu mode.

**If the sleep time is long, battery consumption is high, so setting the minimum value of 1m can reduce battery consumption.**

### Checking a serial number

In the menu mode, select 7.serial number by using the UP and DOWN buttons.

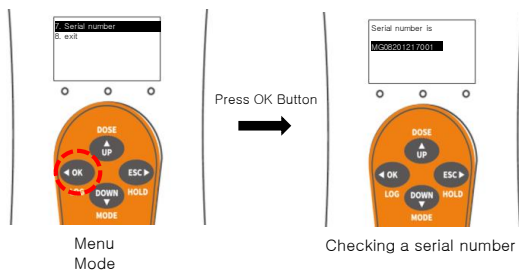

Check the serial number and press ESC button to return to measurement mode.

### Exit from Menu Mode

In the menu mode, select 8.exit by using the UP and DOWN buttons and press the OK button.

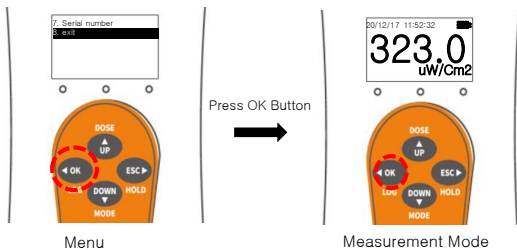

Downloading a log file using a smartphone or laptop in AP mode.

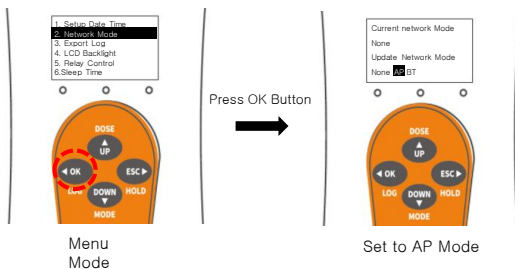

Select AP in network setting mode and press OK button for 1 second to return to menu mode.

In the menu mode, Select 8.exit and return to measurement mode.

Turn the power off and on again.

- 1) Turn on the WiFi of your smartphone or laptop and connect it to the MGx.
- 2) Turn on your Internet browser and enter <http://192.168.0.1/log/>.
- 3) Move to the desired directory and click the log file.
- 4) To download, right-click and select Download.

### 5-6) Measuring the light power

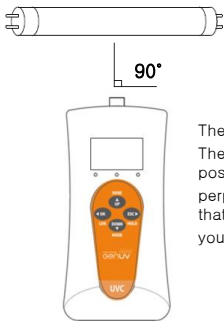

The sensor is located on the top of the body. The measurement surface of the sensor is positioned perpendicular to the UV light source or solar light that you want to measure.

### 5-7) Notify when to replace the battery

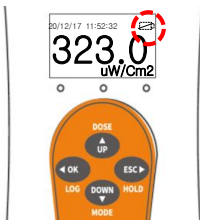

If the LCD does not have any remaining battery meter, please replace the battery.



## 6. FAQ

Error item	Check list
When power is not turned on	Press and hold the power button for more than 3 seconds. A short push will not power up.
	Please make sure that 9V battery is installed.
	Make sure that the battery power is at least 7 V. If it is below 7 V, the power is not turned on or low battery picture is output.
When the screen is dimmed	Please replace the battery. Depending on the voltage consumption of the battery, the screen may become blurred.
the battery change picture is displayed	This indicates when the battery should be replaced. Please replace the battery.
When the measured value is [0.0]	Check that the light source is on. For UV index meters, measurements may be impossible on cloudy days.
	Make sure that the incident surface of the sensor probe is perpendicular to the light source.
	Check the detection wavelength range of the measuring instrument and the wavelength of the light source. The detection wavelength range can be found on page 4 of the manual and on the back of the measuring instrument.
When the measured value differs depending on the light source	Please check page 15 relative response curve. Even if included in the measurement range, the output value may vary depending on the wavelength of the light source. The calibration light source information for the measuring instrument can be found on page 14.
When the measured value is measured low	In the case of a UV index meter, the measured value may be low or not measured on cloudy days.
	Make sure that the sensor measuring surface is positioned perpendicular to the light source. If the angle is tilted, accurate measurements will not be made.
	Check if there is foreign substance on the sensor measurement surface. Foreign matter such as oil or dust can cause a decrease in light quantity.
When power is off during use	If sleep time is not "Infinite", the power is automatically turned off. In this case, it is in normal operation.

## 7. A/S request in case of product failure

- Should any failure is found in product, please call the sales company or customer center for A/S.
  - Product warranty period is 1 year from the date of procurement with no charge. However, failure which is caused by user's misuse or carelessness within warrant period or any failure after the warrant period shall be chargeable for it's A/S.
  - Product inquiry and on-line customer service Tel : +82-42-862-3982, Fax : +82-42-862-2982
- E-mail : [uvsensor@geni-uv.com](mailto:uvsensor@geni-uv.com) Website : <http://www.geni-uv.com>

# MEMO

---

Genuine UV Technology

GENUV